

Key

01A **ROAD CLOSED** (750mm)

01 **ROAD CLOSED**

02 **Diverted traffic** (Right)

03 **Diverted traffic** (Left)

04 **Diverted traffic** (Right)

05 **Diverted traffic** (Left)

06 **Diverted traffic** (Right)

07 **Diverted traffic** (Left)

08 **Diversion** (Up)

09 **Diversion** (Down)

10 **ROAD AHEAD CLOSED**

11 **Diverted traffic** (Right)

12 **Diverted traffic** (Left)

13 **Diverted traffic** (Right)

14 **Diverted traffic** (Left)

15 **NO THROUGH ROUTE**

16 **ROAD AHEAD CLOSED**

17 **ROAD AHEAD CLOSED**

BRADFIELD COLLEGE CONSTRUCTION TRAFFIC FOLLOW DIVERSION

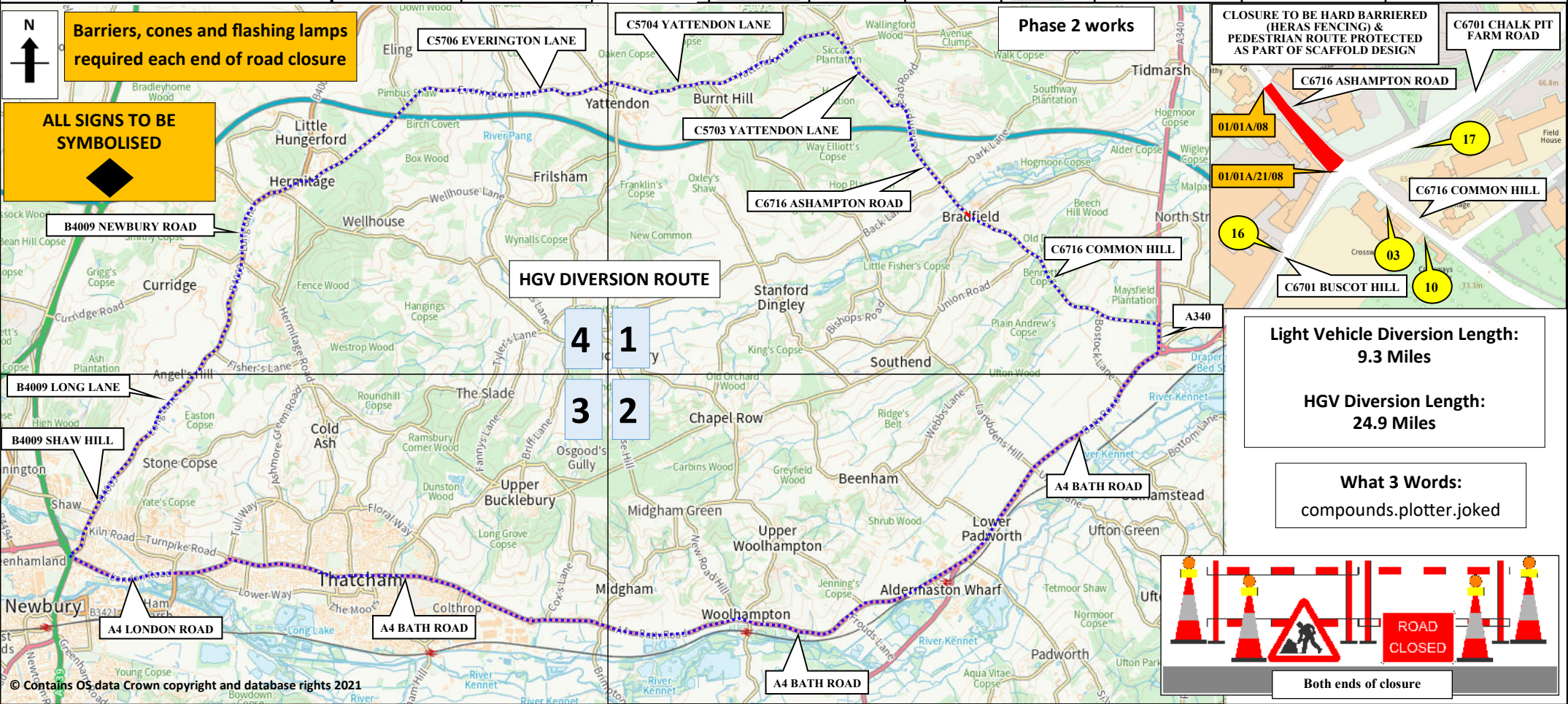

© Contains OS data Crown copyright and database rights 2021

SUNBELT RENTALS

Sunbelt Rentals UK (Traffic Management)
 Kemble Airfield Enterprise Park
 Cirencester Road
 Kemble
 GL7 6BQ
 ☎ 03700 500 792
 📠 0845 004 7105

Note

- All equipment shall be approved and shall comply with the Department Of Transport specification MCE0111. This drawing does not show the normal road works signage that will be required as per Chapter 8.
- All signs to be in accordance with TSRGD 2016 and to minimum class retroreflective.
- Minimum height of lettering to be 60mm and sign boards to be 1000mm (750mm where appropriate). This drawing is protected by copyright and the information contained therein is confidential. This drawing may not be copied and the information therein may not be used, or disclosed to a third party, wholly or in part with the written permission of Sunbelt Rentals UK (Traffic Management).

CROWN COPYRIGHT DATA REPRODUCED BY PERMISSION OF THE CONTROLLER OF HMSO

CLIENT DETAILS		REP/DEPOT	DRAWN BY	ADDRESS
Bradfield College		DFP/213	DFP/213	HGV Diversion route Bradfield College Ashampton Road Bradfield West Berkshire RG7 6AU
DATE	SHEET No	VERSION NUMBER		BUS ROUTE AFFECTED
12/09/2023	1 of 6	002		
AMENDED DATE	AMENDED BY	SCALE		BUS ROUTE AFFECTED
05/10/2023	DFP/213	NOT TO SCALE		
This layout is for installation by NRSWA, Lantra 12A,12B,12D qualified persons.				

	ROAD CLOSURE		CLOCKWISE DIVERSION
	DIVERSION		ANTI-CLOCKWISE DIVERSION
	ROAD CLOSURE SIGN		
ROAD CLOSURE LENGTH (APPROX)		85 M	
ROAD CLOSURE WIDTH (APPROX)		5 M	
Contract Number 213-S013851			